

100 kW | Rental Diesel Generator Set

Genpowerusa GPR-J100-60T3F

EPA Tier 3 FLEX T.P.E.M.

60
Hz



1/3
PH



GENERAL POWERTM
THE GENERATOR COMPANY



Power Ratings

103kW 129kVA Standby ESP

93kW 116kVA Prime PRP

John Deere Engine

158bHP 4045HF285-3158

EPA Tier 3 TPEM Flex

Leroy Somer Alternator

295.6 sKVA Tal-044-H 3Phase

Deep Sea Controller

DSE7320

ABB Circuit Breaker

T-Max Range

Corrosion-Proof Silent Enclosure

AL5052 Aluminum w/ Stainless Steel Hardware

Your mobile power generation solution

Powered by the most reliable components in the industry: Tier 3 FLEX John Deere diesel engines, Leroy Somer alternators, Deep Sea digital controllers, and ABB circuit breakers, GENPOWERUSA Rental-Grade diesel generator sets have been meticulously designed to deliver maximum ROI, versatility and dependability for even the most demanding mobile and prime applications

Voltage	Power ESP kWe/kVA	Power PRP kWe/kVA	Standby Amps	Prime Amps	Phase
480/277	103/129	93/116	155	140	3
208/120	103/129	93/116	357	323	3
240/120	69/69	65/65	288	271	1

POWER DEFINITION

PRP : Prime Power is available for an unlimited number of annual operating hours in variable load applications, in accordance with ISO 8528-1.

ESP : The standby power rating is applicable for supplying emergency power in variable load applications in accordance with ISO 8528-1.

Overload is not allowed.

TERM OF USE

Standard reference conditions ESP/PRP 25 C°/25 C° Air Intlet Temp, 1000 m/1000 m m A.S.L. 60 % relative humidity.

Dimensions Generator	Dimensions Trailer Mounted	Fuel Tank	Trailer
L: 2968 mm (116.9 in)	L: 4445 mm (175 in)	662 L	7000 lbs GVWR
W: 1136 mm (44.7 in)	W: 1829 mm (72 in)	175 Gal	2-axle tandem
H: 2312 mm (91.0 in)	H: 2921 mm (115 in)	23 Hours at 100% PRP	Electric brakes
Dry: 1364 kg (3007 lbs)	Dry: 1895 kg (4177 lbs)	28 Hours at 75% PRP	D.o.T Compliant
Wet: 1960 kg (4320 lbs)	Wet: 2490 kg (5490 lbs)		



GENERAL POWER LIMITED, INC.
9930 NW 21st Street, Miami FL 33172 USA | 305-471-9566 / 1-888-POWER58
www.genpowerusa.com | generators@genpowerusa.com

Spec Sheet
1 of 7

Rental Features

Standard Controller



DEEPSEA DSE 7320: Digital + Auto start/stop

The Deepsea DSE 7320 control features both Manual and Automatic start/stop control of the generator and full CANBUS connectivity for control and protection. The 132x64 LCD display, Emergency stop button and five key menu are highly ergonomic and intuitive. This controller is designed tough and durable for heavy-duty applications while maintaining a high level of sophistication, removing multiple analogue gauges and switches. It has a live display of critical generator and engine performance values that can be easily read on main screen.

- Fully configurable via a free downloadable PC software
- Remote start capability
- 250 events log including date & time make fault finding effortless
- Remote monitoring and control via Ethernet/RS485 and SMS messaging via GSM/SIM card options available
- Coolant temperature and Oil pressure alarm/shutdown
- Oil pressure and low pressure alarm/shutdown
- Oil temp, hours, battery charge, Frequency, Kw, KVA and PF display
- Voltage under/over protection, Amp over current protection, and More!

Voltage Selector Switch

sälzer

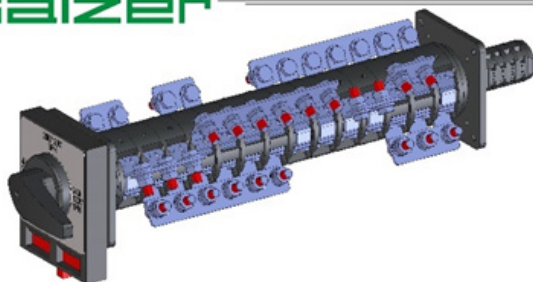

SALZER Series S600

The Salzer S600 series is a rotary cam lockable switch, manually operated and independently programmed for rapid and efficient voltage selection. This voltage changeover switch is securely installed on a IP23 drip-proof protected cabinet inside the enclosure. It comes with a durable legend plate properly labeled from the factory.

- 3-position, lockable, manual switch featuring standard voltage positions of 208/120 3ph, 240/120 1ph and 480/277 3ph
- 3 voltage position pre-programmed, controller programming no needed
- Switch is lockable to prevent voltage change while unit is running or operated

Distribution Panel

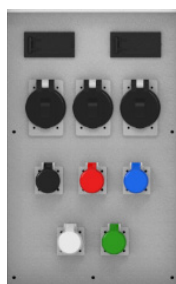

Rental Type Distribution Panel

A full rental-type distribution and quick-field-connections panel has been designed to withstand heavy use while being strategically located for maximum safety, ease of access and user ergonomics. The panel includes:

- 2x 20A GFCI Duplex Outlet
- 3x 50A 125/250V Twist Locks
- 5x 400A E1016-series female camlock connectors with flip covers.
- 5x 400A single conductor 350mcm mechanical lugs

PMG

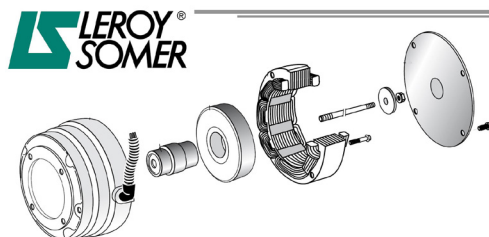

Permanent Magnet Generator (PMG)

The Permanent Magnet Generator (PMG) is the most trusted form of alternate excitation. It is an extension at the non-drive end of the alternator to produce constant power for the AVR. By placing this magnetic generator we guarantee a constant input of power for the AVR that otherwise would not be possible with a self-excited system. This excitation method is commonly used for applications with high performance requirements for motor starting, selective coordination and non-linear loads.

- High overload capacity (load impact or starting electric motors) which can short-circuit (300% - 10 s)
- Minimum susceptibility to non-linear loads
- High motor starting capacity
- Improves performance of SHUNT system
- 295.6 Starting kVA (SkVA) @ +/- 30% voltage dip

Rental Features

Circuit Breaker

ABB T-Max Range



The top quality materials and innovative construction techniques used by ABB mean T-max circuit breakers assure exceptional performance. The series of units, equipped with latest generation technology, offers solutions exclusive to ABB.

- New wiring system means no loose wires inside the circuit breaker
- Breakers can be used in temperature between -13 °F and +158 °F

- T5 available from 300A up to 600A
- T6 available from 600A up to 800A
- T7 and T7M available from 1000A up to 1200A
- T8 available from 1600A up to 3000A

Trailer

DOT Compliant Heavy Duty Road Trailer



- 7000 lbs G.V.W.R
- Dual-axle trailer with electric brake system on both axles with battery back-up breakaway system
- 4x ea, 205/75D15H188ST bias 6 ply load range C tires
- 1x ea, 2 5/16" ball hitch coupler with adaptability for Lunette eye
- 1x ea, 4 hole 3 position 14K mount channel
- 1x ea, 1/4" x 30" safety chains
- 1x ea, 7K top wind tongue mounted jack
- 2x ea, 7K side wind jacks on rear
- Running lights with 7-wire harness and connector
- Weight bearing fenders up to 227 kg (500 lbs.)

Fuel Tank

True Double-Walled Fuel Tank



- 175 Gal capacity
- 23 hours runtime @ 100% load PRP
- 28 hours runtime @ 75% load PRP
- Eco-friendly steelbase welded sub-base fuel tank
- Internal filling system and 110% containment capability of any spills
- Tank includes: electronic fuel level sender, mechanical fuel level gauge, low level switch, leak detection switch and atmospheric vent

Lifting Kit

Heavy-duty Single-Point Lifting Kit (optional)



The single-point lift kit has been designed to withstand substantial use and to provide fleet owners and operators:

- Flexible and adaptable maneuverability between job sites and obstacles
- Effortlessly and safely move, load and unload generator independently or with the trailer attached
- An added level of robust perimeter protection
- Engine access with a completely beam-less design featuring the industry's first 110% access to the engine and radiator, on both sides. Over 36 square feet of unrestricted clearance guaranteeing unrivaled operator ergonomics, safety, productivity, minimum down time, and maximum user satisfaction.

John Deere Engine Specifications

General Data

Manufacturer	John Deere 4045HF285-3158 Turbocharged & Aftercooled (air-to-air) EPA Tier 3 Flex
Cylinders-arrangement	4-L
Displacement	4.5-L
Bore (mm) X Stroke (mm)	106X127
Compression Ratio	19.0:1
Speed (RPM)	1800
Maximum stand-by power at rated RPM (kW)	118 kW (158HP)
Governor	Electronic

Fuel Consumption

Fuel consumption 100% Prime load	29.2 L/hr [7.7 Gal/hr]
Fuel consumption 75% Prime load	23.3 L/hr [6.2 Gal/hr]
Fuel consumption 50% Prime load	16.7 L/hr [4.4 Gal/hr]

Fuel Runtime Autonomy

Integral Tank (175 Gal)	23 Hours @ 100% Prime
	28 Hours @ 75% Prime
	39 Hours @ 50% Prime

U.S. EPA Compliance

EPA Tier	U.S. EPA Tier 3 Flex
TPEM (Transition Program for Equipment Manufacturers)	Yes, as per Flexibility Allowance Provisions
TPEM Regulation	40 CFR §1039.625
Mobile Prime Application	Yes, compliant for mobile prime application
Stationary Standby Application	No, does not comply. Must use Tier 3 Stationary Emergency only.
Stationary Prime Application	No, does not comply. Must use Tier 4 Final only
Additional information and purchasing guide	Click here

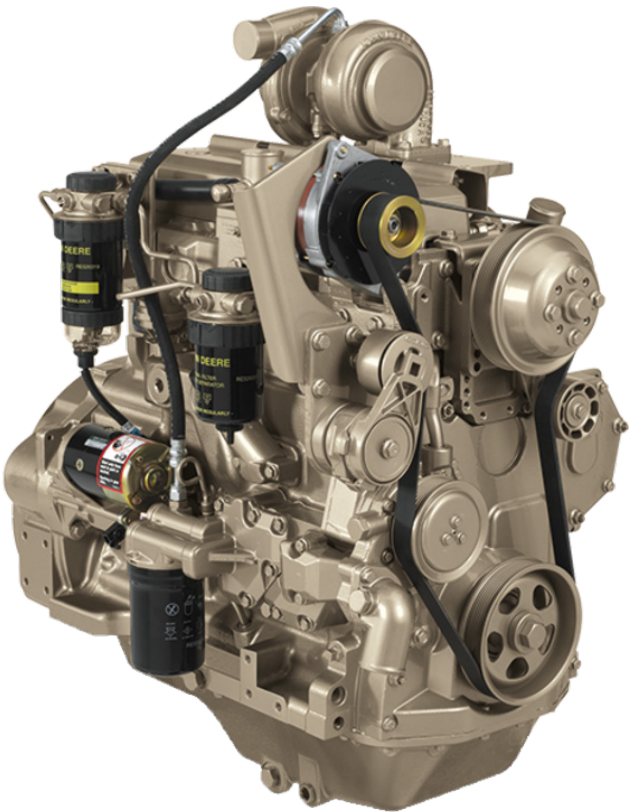

Leroy Somer Alternator Specifications

General Data

Manufacturer	Leroy Somer
Alternator	TAL-44-H
Starting KVA	295.6 at 30% voltage dip
Number of phases	3
Power factor (Cos Phi)	0.8
Altitude (M)	<1000
Overspeed (RPM)	2250
Number of poles	4
Excitation System	P.M.G. Permanent Magnet Generator
Short circuit capability	300% for 10 seconds
Insulation class/ Temperature class	H / H
Automatic Voltage Regulator	Leroy Somer R438
Coupling	Direct / Single Bearing
Voltage regulation 0 to 100%	+/- 0.5%



GP-4045-R Enclosure

Weatherproof, Super silent, Marine-grade resistance

Standard Features

12-GAUGE, AL5052-ALUMINUM enclosure construction and stainless steel hardware for EXCEPTIONAL corrosion resistance

Powder coated with high durability polyester resin thermosetting powder paint for maximum longevity

28-33db Aluminized steel construction Miratech COWL® CRITICAL silencer. Internally-mounted on isolated sound-attenuated compartment with vertical gases exhaust for maximum sound reduction

Sound attenuating cooling air discharge design. Weather protective design features a vertical air discharge outlet grille to redirect cooling air up and above enclosure to minimize sound emissions

Up to 51 mm (2 in) acoustic insulation with hydrocarbon sealing film that meets FMVSS 302 flammability classification and repels moisture absorption

GENPOWERUSA 110%-ACCESS™. XXL enclosure access featuring a beamless design for industry-leading 110% access to the engine and radiator from both sides

DUAL-CRITICAL-ACCESS emergency stop buttons: The primary one is externally mounted and recessed on the enclosure next to the engine compartment and a secondary internally mounted inside the enclosure next to the generator controller



GPR-J100-60T3F Rental Generator Features

SINGLE POINT LIFTING KIT.

Provides robust perimeter protection and reliable lifting capability for the generator set and trailer (optional)

ROBUST ALUMINUM CONSTRUCTION

12-gauge, AL5052 aluminum construction and stainless steel hardware for EXCEPTIONAL corrosion resistance

DUAL E-STOP BUTTONS

Dual Critical-Access emergency-stop buttons located on the engine access compartment and on the control cabinet.

RENTAL-TYPE DISTRIBUTION PANEL

2x 20A GFCI Duplex Outlet
3x 50A 125/250V Twist Locks
1x Set 400AMP E1016 series female camlock panel mounts with flip covers

RENTAL TYPE LUGS PANEL

1x Set single conductor 350mcm mechanical lug (1x per phase, 1 neutral and 1 ground)

23 HOURS RUNTIME AUTONOMY

175 Gal integral fuel tank with electronic fuel level sender, low level alarm, leak detection alarm and mechanical fuel level gauge
23 hours runtime autonomy at 100% PRP load.
28 hours runtime autonomy at 75% PRP load.



GENPOWERUSA 110%-ACCESS™

XXL enclosure access featuring a beamless design for industry-leading 110% access to the engine and radiator from both sides

TIER 3 FLEX JOHN DEERE ENGINE

T.P.E.M. tier 3 engine is a fully compliant alternative to tier 4 final models that ensures lowest possible acquisitions cost and ease of operation in a dependable, field-proven design.

MIRATECH COWL® CRITICAL SILENCER

Aluminized steel construction internally-mounted on isolated sound-attenuated compartment with vertical gases exhaust for maximum sound reduction

REAR CONTROL AND CONNECTIONS ACCESS

Located in isolated compartment for safer and quieter operation

110% ENVIRONMENTAL CONTAINMENT

True double-walled construction with 110% containment capability for all fluids. Segmented containment design allows for separation of oil-coolant, fuel and water.

